

FTTx – Fibre Optics Connectivity

As well as Volition™ Network Solutions, 3M™ offers a complete line of single-mode & multimode ferruled fibre optic connectors including Hot Melt and Crimplok™ connectors in ST, SC, FC and LC style. To complement this, connectors are also available terminated as pigtails or patch cords in a variety of lengths.

There is also an extensive range of mounting hardware & accessories including 19" patch panels and distribution boxes. The Fibrlok™ mechanical splice, available in single- and multimode versions for single- and multimode fibre completes the offering of Fibre Interconnect Solutions.

8.1	Couplings, Connectors, Pigtails	Page
	8.1.1 3M™ ST-Connectivity	332 - 333
	8.1.2 3M™ SC-Connectivity	334 - 336
	8.1.3 3M™ LC-Connectivity	337 - 338
	8.1.4 3M™ FC-Connectivity	339 - 340
	8.1.5 E2000-Connectivity	341
8.2	Assembly Systems	
	8.2.1 3M™ Hot Melt System	342 - 346
	3M™ HotMelt Universal Termination Kit	342
	Accessories and Consumables	343 - 345
	Autopolisher and Tubing Kit	346
	8.2.2 3M™ Crimplok™ Connectors	347
	8.2.3 3M™ Fibrlok™	348 - 349
8.3	Cable Assemblies	
	8.3.1 3M™ Multimode patch cords	350 - 352
	Multimode ST-ST , SC-SC patch cords	350
	Multimode ST-SC, MTRJ-ST, MTRJ-SC	351
	Multimode SC-LC, LC-LC	352
	8.3.2 3M™ Single-mode patch cords	353 - 355
	Single-mode patch cords ST, SC	353
	Single-mode patch cords SC/APC	354
	8.3.3 3M™ DIN Splicing Cassette	355
8.4	Distribution Boxes	
	8.4.1 3M™ VKA/GF	356 - 358
	3M™ VKA 2/GF	356
	3M™ VKA 2/GF-EFM	357
	3M™ VKA 4/GF, VKA 8/GF	358
	8.4.2 3M™ 2552 SA	359

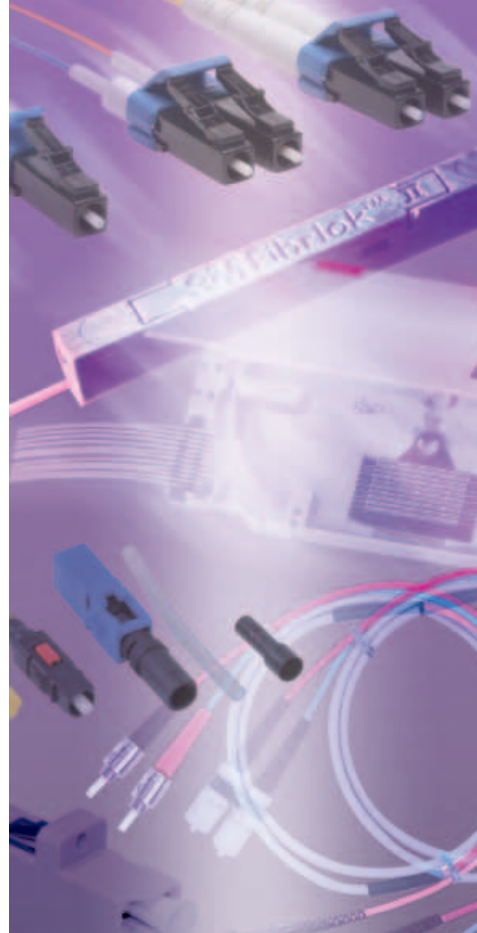

8







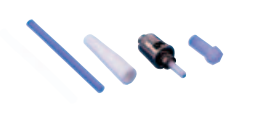
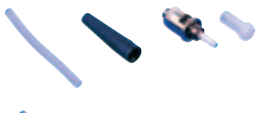

8.1 Couplings, Connectors, Pigtails

8.1.1 3M™ ST-Connectivity

Type/Order text	Ref.-No.
-----------------	----------

3M™ ST Connectors

	ST connector - Hot Melt - multimode White boot PU: 60 pcs PU: 1000 pcs	6100-W 6100-W1K
	Black boot PU: 60 pcs PU: 1000 pcs	6100-B 6100-B1K
	Red boot PU: 60 pcs PU: 1000 pcs	6100-R 6100-R1K
	ST connector - Hot Melt - single-mode Yellow boot PU: 60 pcs	8100-YS
	Black boot PU: 60 pcs PU: 1000 pcs	6105-B 6105-B1K
	Red boot PU: 60 pcs	6105-R
	ST connector Epoxy - single-mode Yellow boot PU: 60 pcs	8106
	Blue boot PU: 60 pcs	AAMUL3
	ST connector - Crimplok - multimode Grey boot PU: 60 pcs	6901
	ST connector - Crimplok - single-mode Blue Boot PU: 60 pcs	8901

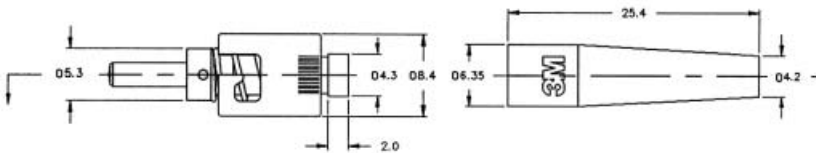

Connector type	6100	6105	6901	8100	8106	8901
Adhesive type	Hot Melt	Exoxy	None, crimp	Hot Melt	Epoxy	None, crimp
Fibre Type	50/125, 62,5/125	50/125, 62,5/125	50/125, 62,5/125	9/125	9/125	9/125
Insertion loss	< 0,20 dB typ.	< 0,20 dB typ.	< 0,20 dB typ.	< 0,20 dB typ.	< 0,30 dB typ.	< 0,20 dB typ.
Return loss	≥ 25 dB typ.	≥ 25 dB typ.	≥ 40 dB typ.	≥ 40 dB typ.	≥ 45 dB typ.	> 40 dB typ.
Ferrule	Ceramic	Ceramic	Ceramic	Ceramic	Ceramic	Ceramic
Housing / Body	Metal	Metal	Plastic	Metal	Metal	Plastic
Boot colour	white/black/red	black/red	grey/blue	yellow	yellow	blue
Operating temperature	-10°C to +60°C	-40°C to 85°C	-10°C to 60°C	-10°C to +60°C	-40°C to 85°C	-40°C to 85°C
Storage temperature	-40°C to 85°C	-40°C to 85°C	-40°C to 85°C	-40°C to 85°C	-40°C to 85°C	-40°C to 85°C

8.1 Couplings, Connectors, Pigtails

8.1.1 3M™ ST-Connectivity



FTTx – Fibre Optics Connectivity

Type/Order text

Ref.-No.

3M™ ST Couplings / ST Pigtails



ST Coupling, multimode

for D hole mounting, spacer and union nut included

PU: 60 pcs

PU: 1000 pcs

6112

6112-1K

ST Coupling, single-mode

for D hole mounting, spacer and union nut included

PU: 60 pcs

8119



ST Pigtail 50/125, multimode Fibre, green, easy strip

Length: 2 m, PU: 12 pcs

BAN00-ZK0002

ST Pigtail 62.5/125, multimode Fibre, blue, easy strip

Length: 2 m, PU: 12 pcs

BNA00-AP0002

ST Pigtail 9/125, single-mode Fibre, yellow, easy strip

Length: 2 m, PU: 12 pcs

AAM00-AU0002

ST Coupling

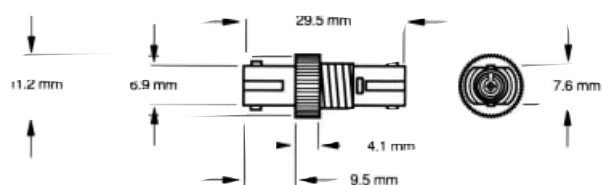

Hole pattern

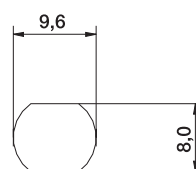



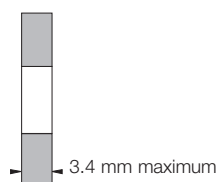



Sheet thickness



Coupling type	6112	8119
Type	Multimode	Single-mode
Sleeve	Phosphor bronze	Zirconia ceramic
Housing	Metal	Metal
Operating temperature	-40°C to 85°C	-40°C to 85°C

8.1 Couplings, Connectors, Pigtails

8.1.2 3M™ SC-Connectivity

Type/Order text	Ref.-No.
 <p>SC-Connector Hot Melt, multimode, white boot PU: 60 pcs PU: 1000 pcs</p>	<p>6300-W 6300-W1K-S</p>
 <p>SC-Connector Ultra High Temperature Hot Melt, single-mode blue boot PU: 60 pcs PU: 1000 pcs</p>	<p>8308-U 8308-U1K</p>
 <p>SC-Connector Epoxy, single-mode, white boot PU: 60 pcs</p>	<p>8306</p>
 <p>SC/APC-Connector, single-mode, green boot PU: 60 pcs PU: 1000 pcs</p>	<p>8306-SC/APC AEPGL-3</p>
 <p>SC-Connector Crimplok, single-mode, black boot PU: 60 pcs</p>	<p>6900</p>
 <p>SC-Connector Crimplok, multimode, black boot PU: 60 pcs</p>	<p>8900</p>

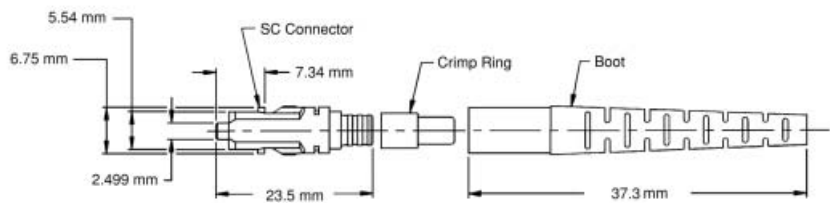

SC Connector	6300 W	8308 U	8306	8306-SC/APC AEPGL-3	6900	8900
Adhesive type	Hot Melt	Hot Melt	Epoxy	Epoxy	None, crimp	None, crimp
Fibre Type	50/125 62.5/125	9/125	9/125	9/125	50/125 62.5/125	9/125
Insertion loss in dB typ.	< 0,20	< 0,20	< 0,30	< 0,30	< 0,20	< 0,20
Return loss in dB typ.	≥ 25	≥ 55	≥ 45	≥ 65	> 27	≥ 40
Ferrule	Zirc. ceramic	Zirc. ceramic	Zirc. ceramic	Zirc. ceramic	Zirc. ceramic	Zirc. ceramic
Housing / Body	Plastic	Plastic	Plastic	Plastic	Plastic	Plastic
Boot colour	White	Blue	White	Green	Black	Black
Operating temp. in °C	-10 to 60	-40 to 100	-40 to 85	-40 to 85	-10 to 60	-10 to 60
Storage temp. in °C	-40 to 85	-40 to 100	-40 to 85	-40 to 85	-40 to 80	-40 to 80

8.1 Couplings, Connectors, Pigtails

8.1.2 3M™ SC-Connectivity



FTTx – Fibre Optics Connectivity

Type/Order text

Ref.-No.

3M™ SC Couplings / Pigtails



SC Duplex Coupling, multimode
Plastic housing, grey, mounting bracket included
PU: 60 pcs

6313

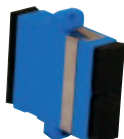

SC Duplex Coupling, single-mode
Plastic housing, blue, mounting bracket included
PU: 60 pcs

8313



SC Coupling, multimode
Simplex, grey, mounting springs included
PU: 60 pcs

6310



SC Coupling, single-mode
Simplex, blue, mounting springs included
PU: 60 pcs

8310-E



SC/APC Coupling, single-mode
Simplex, green, mounting springs included
PU: 60 pcs

8310-GE

SC duplex coupling

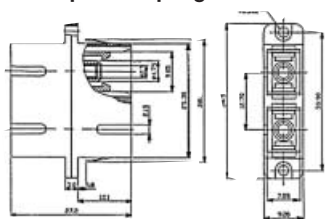

Hole pattern

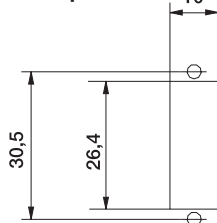

Sheet thickness

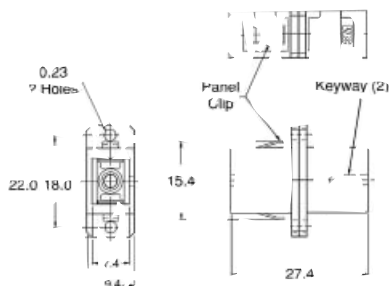
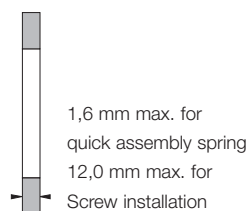

Hole pattern

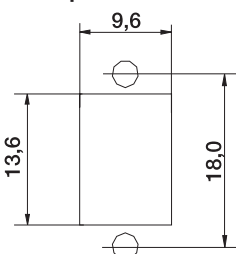

Coupling/Connector type	6313	8313	6310	8310-E	8310-GE
Type	Multimode	Single-mode	Multimode	Single-mode	Single-mode
Simplex/Duplex	for duplex	for duplex	simplex	simplex	simplex
Sleeve	Phosphor bronze	Zirconia ceramic	Zirconia ceramic	Zirconia ceramic	Zirconia ceramic
Housing	Plastic, gray	Plastic, blue	Plastic, grey	Plastic, blue	Plastic, green
Operating temp.	-40°C to 75°C	-40°C to 85°C	-40°C to 85°C	-40°C to 85°C	-40°C to 85°C









8.1 Pigtails

8.1.2 3M™ SC-Connectivity

Type/Order text

Ref.-No.

3M™ SC Pigtails

	SC Pigtail 50/125, multimode fibre, OM2, easy stripp Length: 2 m, PU: 12 pcs	BDB00-ZK0002
	SC Pigtail 50/125, multimode fibre, OM3, easy stripp Length: 2 m, PU: 12 pcs	BDB00-ZO0002
	SC Pigtail 62.5/125, multimode fibre, OM1, easy stripp Length: 2 m, PU: 12 pcs	BDB00-AP0002
	SC Pigtail 9/125, single-mode fibre, easy stripp Length: 2 m, PU: 12 pcs	ADA00-AU0002
	SC Pigtail 9/125, single-mode fibre tight buffer Length: 2 m, PU: 12 pcs	ADAOO-AU0002
	SC/UPC Pigtail 9/125, single-mode fibre, easy stripp Length: 3 m, PU: 12 pcs	AEQOO-AU0003
	SC APC 8° Pigtail 9/125, single-mode fibre, easy stripp Length: 2 m, PU: 12 pcs	ADE00-AU0002
	SC APC 9° Pigtail 9/125, single-mode fibre, easy stripp Length: 2 m, PU: 12 pcs	ABP00-AU0002

8.1 Couplings, Connectors, Pigtails

8.1.3 3M™ LC-Connectivity



Description

3M™ LC Connectors / Couplings / Pigtails

The LC small form factor connector has become the most popular interface for optical line equipment over the last two years and is well established in fibre backbones.

3M has expanded their attractive productline of Hot Melt fibre optic connectors and now offers also LC Hot Melt connectivity for single- and multimode applications.

The 3M Hot Melt system combines the ease of installation together with the advantage of spliceless direct termination in patch panels and TO's.

Due to it's small size, the LC-Connector allows to double the port density in 19" cabinets. By design the LC has a very low crosstalk and makes the connector the perfect choice for 1 GBit/s as well as 10 GBit/s applications.

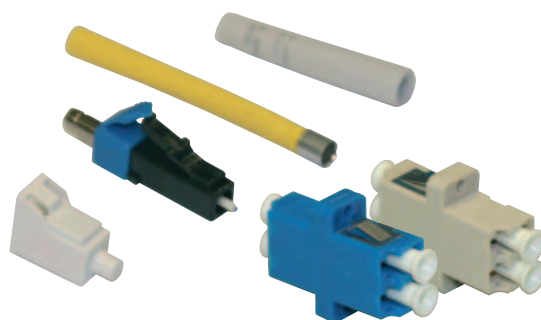





3M™ LC Connectors Hot Melt

Ref.-No.

3M™ LC Couplings

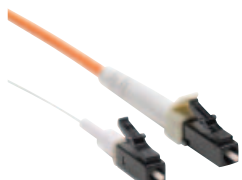
Type/Order text

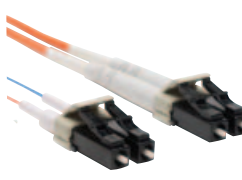
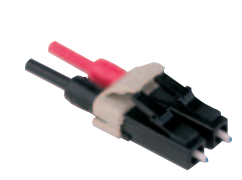
Ref.-No.

	LC-Connector Hot Melt, multimode, for 900µm fibre, short boot, white, for outlets Simplex, beige, PU: 60 pcs	6600-S
	LC-Connector Hot Melt, multimode, for 1,6-2,0 mm cable, standard boot, white Simplex, beige, PU: 60 pcs	6602-S
	LC-Connector Hot Melt, multimode, for 2,4-3,0 mm cable, standard boot, white Simplex, beige, PU: 60 pcs	6603-S
	LC-Connector Hot Melt, multimode, for 900µm fibre, standard boot, white/beige Duplex with clip, beige, PU: 60 pcs	6601-D
	LC-Connector Hot Melt, multimode, for 1,6-2,0 mm cable, standard boot, white/beige Duplex with clip, beige, PU: 60 pcs	6602-D
	LC-Connector Hot Melt, multimode, for 2,4-3,0 mm cable, standard boot, white/beige Duplex with clip, beige, PU: 60 pcs	6603-D
	LC-Connector Hot Melt, multimode, for 900µm fibre, standard boot, black/red Duplex with clip, beige, PU: 60 pcs	6604-D
	LC-Connector Hot Melt, multimode, for 1,6-2,0 mm cable, standard boot, black/red Duplex with clip, beige, PU: 60 pcs	6605-D
	LC-Connector Hot Melt, multimode, for 2,4-3,0 mm cable, standard boot, black/red Duplex with clip, beige, PU: 60 pcs	6606-D

8.1 Couplings, Connectors, Pigtails

8.1.3 3M™ LC-Connectivity

Description

	LC-Connector Hot Melt, single-mode, for 900µm fibre, short boot, white, for outlets Simplex, blue, PU: 60 pcs	8600-S
	LC-Connector Hot Melt, single-mode, for 1,6-2,0 mm cable, standard boot, white Simplex, blue, PU: 60 pcs	8602-S
	LC-Connector Hot Melt, single-mode, for 2,4-3,0 mm cable, standard boot, white Simplex, blue, PU: 60 pcs	8603-S
	LC-Connector Hot Melt, single-mode, for 900µm fibre, standard boot, white/beige Duplex with clip, blue, PU: 60 pcs	8601-D
	LC-Connector Hot Melt, single-mode, for 1,6-2,0 mm cable, standard boot, white/beige Duplex with clip, blue, PU: 60 pcs	8602-D
	LC-Connector Hot Melt, single-mode, for 2,4-3,0 mm cable, standard boot, white/beige Duplex with clip, blue, PU: 60 pcs	8603-D
	LC-Coupling, multimode Duplex, beige plastic housing in SC-Simplex format PU: 60 pcs	6661-DC
	LC-Coupling, single-mode Duplex, blue plastic housing in SC-Simplex format PU: 60 pcs	8661-DC
	LC-Coupling, single-mode Simplex, blue plastic housing PU: 60 pcs	8662-SC
	LC-Pigtail 50/125, multimode Green, length: 2 m, PU: 12 pcs	BDUOO-ZK0002
	LC-Pigtail 50/125, multimode OM3 Green, length: 2 m, PU: 12 pcs	BDUOO-ZO0002
	LC-Duplex Pigtail 50/125, multimode Green, length: 2 m, PU: 6 pcs	BDUOO-CT0002
	LC-Duplex Pigtail 50/125, multimode OM3 Green, length: 2 m, PU: 6 pcs	BDUOO-CB0002
	LC-Pigtail 62,5/125, multimode Blue, length: 2 m, PU: 12 pcs	BDBOO-AP0002
	LC Pigtail 9/125, single-mode Yellow, length: 2 m, PU: 12 pcs	ADVOO-AU0002
	LC/APC Pigtail 9/125, single-mode Yellow, length: 2 m, PU: 12 pcs	ADWOO-AU0002

8.1 Couplings, Connectors, Pigtails

8.1.4 3M™ FC-Connectivity

Type/Order text

Ref.-No.

3M™ FC/PC Connector



FC-Connector, Hot Melt, multimode, white boot
PU: 60 pcs

6200



FC-Connector, Epoxy, single-mode, white boot
PU: 60 pcs
PU: 1000 pcs

**8203
AENWL-3**



FC-Connector, Ultra High Temperature Hot Melt, single-mode
blue boot
PU: 60 pcs
PU: 1000 pcs

**8208
8208-U1K**



FC/APC Connector, Epoxy, single-mode
green boot
PU: 60 pcs
PU: 1000 pcs

**8206-FC/APC
AEXGL-3**

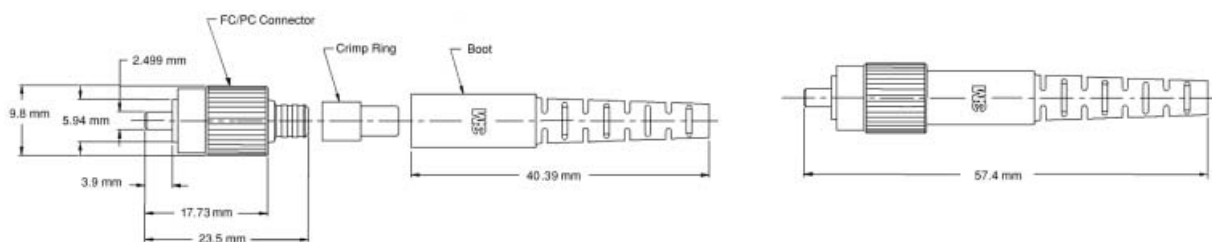

FC Connector	8203 AENWL-3	8208 8208-U1K	8206-FC/APC	AEXGL-3	6200
Adhesive Type	Epoxy	Hot Melt	Epoxy	Epoxy	Hot Melt
Fibre Type	E9/125	E9/125	E9/125	E9/125	G50/125, G62,5/125
Insertion loss in dB typ.	< 0,2	< 0,2	< 0,2	< 0,2	< 0,2
Return loss in dB typ.	≥ 55	≥ 55	≥ 80	≥ 80	≥ 25
Ferrule	Zirconia ceramic	Zirconia ceramic	Zirconia ceramic	Zirconia ceramic	Zirconia ceramic
Housing/body	Plastic	Plastic	Plastic	Plastic	Plastic
Boot colour	White	Blue	Green	Green	White
Operating temp. in °C	-40 to 85	-40 to 100	-40 to 85	-40 to 85	-10 to 60
Storage temp. in °C	-40 to 85	-40 to 100	-40 to 85	-40 to 85	-40 to 85

8.1 Couplings, Connectors, Pigtails

8.1.4 3M™ FC-Connectivity

Type/Order text	Ref.-No.
-----------------	----------

3M™ FC Couplings/Pigtails



FC-Coupling, single-mode

for D hole mounting spacers and nut included
PU: 60 pcs

8211

FC-APC-Coupling, single-mode

for D hole mounting spacers and nut included
PU: 60 pcs

8211-APC



FC-Pigtail 9/125, single-mode Fibre

Length: 2 m
PU: 12 pcs

AEN00-AU0002



FC-APC 8° Pigtail 9/125, single-mode Fibre

Length: 2 m,
PU: 12 pcs

AEX00-AU0002

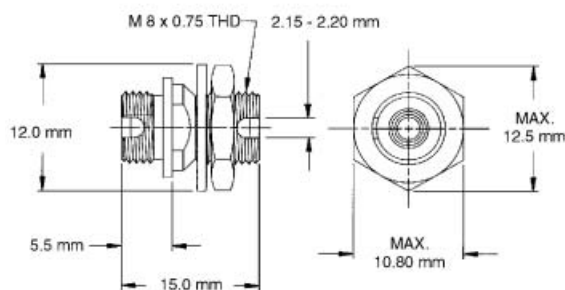

Hole pattern

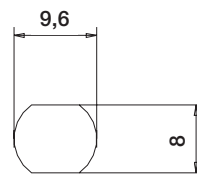

Wall thickness

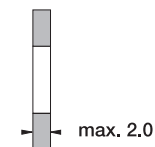

Connector	8211	8211-APC
Type	Singlemode	Singlemode
Sleeve	Zirconia ceramic	Zirconia ceramic
Housing	Metal	Metal
Operating temperature	-40°C to 85°C	-40°C to 85°C

8.1 Couplings, Connectors, Pigtails

8.1.5 E2000 Connectivity



FTTx – Fibre Optics Connectivity



Type/Order text

Ref.-No.

E2000 Couplings/Pigtails

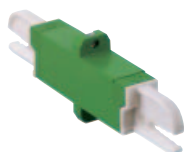

E2000/APC coupling, single-mode
Simplex, green, 2 mounting screws included

05-751-13400

PU: 1 pc



E2000 Simplex, metal mounting clamp
for screw-less mounting of E2000 connectors

05-750-14100

metal, PU: 10 pcs



E2000/APC 8° Pigtail 9/125, single-mode Fibre
Length: 2 m, PU: 1 pc

05-706-03900

Hole pattern

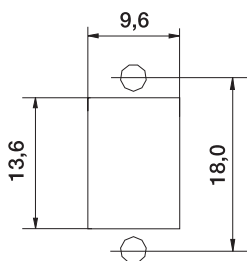

Sheet thickness

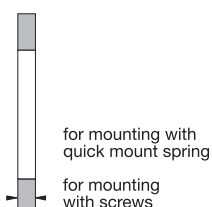

Connector type	E2000/APC
Type	Single-mode
Sleeve	Zirconia ceramic
Housing	Plastic, green
Operating temperature	-40°C to 85°C

Connector type	E2000/APC
Adhesive type	Epoxy
Fibre Type	9/125
Insertion loss	< 0.2 dB typ.
Return loss	> 75 dB typ.
Ferrule	Zirconia ceramic
Housing / Body	Plastic
Boot	green
Operating temperature	-40°C to 85°C
Storage temperature	-40°C to 85°C

E2000 is a trademark of the Diamond Company.

8.2 Assembly Systems

8.2.1 3M™ Hot Melt System Universal Termination Kit

Description

3M™ Hot Melt optical fibre connector assembly system

The 3M Hot Melt system offers most convenient field connectivity for fibre optic connectors. From direct termination of breakout cables in patch panels over pigtails up to patchcords, Hot Melt connectors fit every application. The connectors are pre-filled with Hot Melt adhesive which just needs to be heated for easy termination.

All connectors have ceramic ferrules and different coloured boots enable clear port identification.. A universal termination kit plus different upgrade kits enable to install all type of 3M Hot Melt connectors.

Highlights:

- Quick, simple and safe assembly in the field or factory
- Connector, adhesive and polishing film from one manufacturer guarantees a high quality connector
- Simple polishing process, either manually or with a polishing machine
- All connectors contain a zirconia ferrule and Hot Melt adhesive
- Boots are available in various colours for definite channel separation
- Suitable for all LAN and CATV applications
- Suitable for internal or external applications



Type/Order text

Ref.-No.



Universal Hotmelt Termination Kit

The Hot Melt Termination Kit for ST, SC, FC and LC-Connectors contains all tools and consumables, which are necessary to terminate 3M HotMelt Connectors in the field.

(LC Hot Melt available form Q2/3 2005)

PU: 1 pc

Kit content:

- Hotmelt oven with 230V power cord for europe and UK
- Connector holders for ST (6 ea.), SC and FC (4 ea.)
- Universal connector holder for ST, SC, FC connectors (during 2005)
- Polishing pad, classic, round ("one step")
- Polishing pad, UHT, soft
- Polishing film 2µm, round, light green, 200 ea
- Polishing film 0,5µm, diamond, light gray, 15 ea
- Polishing film 0,5µm, final polish, frosted, 50 ea
- Polishing film 0,05µm, light yellow, 50 ea
- Jacket stripper
- Buffer/coating stripper
- Kevlar sissors
- Universal crimp tool
- Carbide scribe blade
- Angled viewscope (200x)
- Express glue for UHT connectors
- Lint free tissues, 100 ea
- Bottles for water and isoprophyl alcohol
- Safety container for fibre stubs
- Marker
- Trainings CD and instruction manual

6361



8.2 Assembly Systems

8.2.1 3M™ Hot Melt System

Accessories and Consumeables

Type/Order text

Ref.-No.

Accessories/Consumeables



Conversion Kit: Epoxy to Hot Melt Classic

6157

(8361 to 6361)

PU: 1 pc

Content:

- Polishing pad, classic, round, ("one step")
- Connector holders, ST (6 ea)
- Connector holders, FC (4 ea)
- Connector holders, SC (4 ea)
- Hot Melt oven, 230V with power cord, Europe and UK
- Universal polishing jig (2 ea)
- Polishing film 2µm, round, "one step"
- Polishing film, 0,05µm, final polish single-mode (50 ea)
- Instruction manual HotMelt connectors ST, SC, FC
- Operation manual HotMelt Oven

Extension Kit Hot Melt to UHT connectors

6355-U

PU: 1 pc

Content:

- Polishing pad, soft for UHT connectors (1 ea)
- Polishing film 0,5µm, diamond, for UHT connectors (15 ea)
- Polishing film 0,02µm, silicon dioxide for UHT connectors (50 ea)
- Express glue, bottle, for UHT connectors (1 ea)
- Instruction manual UHT connectors



Extension kit LC Hot Melt

6650-LC

PU: 1 ea

- Polishing pad 11,5 x 14 mm (1 ea)
- LC connector holder (4 ea)
- LC polishing jig (2 ea)
- Polishing film starter kit
- LC crimp dies (1 set)
- LC adapter for microscope 200x (1 ea)
- Heat shrink adapter (1 ea)
- Cleaning wires for connector holder (1 set)
- Instruction manual LC Hot Melt



Classic Hot Melt consumeables kit

6365-CC

PU: 1 pc

Content:

- Polishing film 2µm (200 ea)
- Polishing film 0,05µm (50 ea)
- Lint free tissues (200 ea)
- Universal polishing jig (1 ea)



UHT Consumeable kit

6365-CU

PU: 1 pc

- Polishing film 0,5µm (10 ea)
- Polishing film 0,02µm (50 ea)
- Lint free tissues (200 ea)
- Universal polishing jig (1 ea)

LC Hotmelt single-mode polishing film set

6650-LS

- Polishing film 2µm, "One Step" (100 ea)
- Polishing film 9µm (20 ea)
- Polishing film 0,5 µm (40 ea)
- Polishing film, final polish, 0,02µm (80 ea)

LC Hotmelt multimode polishing film set

6650-LM

- Polishing film 2µm, "One Step" (100 ea)
- Polishing film 9µm (20 ea)

8.2 Assembly Systems

8.2.1 3M™ Hot Melt System

Accessories and Consumables

Type/Order text

Ref.-No.

Accessories/Consumables



Polishing film 2µm, "one step" (254 X Classic),
round for handpolish
PU: 50 pcs

6192 A

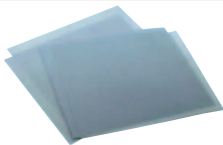

Polishing film 0,5µm, diamond (light gray)
PU: 5 pcs

661X-0,5S



Polishing film 0,5µm, final polish (frosted)
PU: 50 pcs

863X-0,02S



Polishing film 0,02µm, single-mode (light yellow)
PU: 50 pcs

263X



Polishing film 9µm, pre-polish LC-Hotmelt
PU: 50 pcs

461X



Polishing pad, round, handpolish, Classic HotMelt
PU: 1 pc

6365-PP



Polishing pad 11,5 x 14 cm, soft, for UHT connectors
PU: 1 pc

8365-PP



Polishing pad 11,5 x 14 cm, for LC HotMelt connectors
PU: 1 pc

6650-LP



Polishing jig HotMelt, handpolish, ST, SC, FC
PU: 1 pc

8892



Polishing jig, handpolish, HotMelt LC
PU: 1 pc

6650-LJ

8.2 Assembly Systems

8.2.1 3M™ Hot Melt System

Accessories and Consumeables

Type/Order text

Ref.-No.

Accessories/Consumeables



Weight for polishing jig, handpolish, HotMelt LC
PU: 1 pc

6650-JW



Hot Melt oven, 230V
with UK and EU power cord, PU: 1 pc

6323



Lintfree tissues
PU: 200 pcs

05-00017



Bottle for isopropyl alcohol
PU: 1 pc

VOL-0560R



Connector holder for ST Hot Melt connectors
PU: 6 pcs

6190



Connector holder for SC Hot Melt connectors
PU: 4 pcs

SP-00504



Connector holder for FC Hot Melt connectors
PU: 4 pcs

SP-00505



Connector holder for LC Hot Melt connectors
PU: 4 pcs

6650-LH

8.2 Assembly Systems

8.2.1 3M™ Hot Melt System Autopolisher/Tubing Kit

Description

3M Hot Melt Autopolisher / 3M Tubing Kit

The 6851-E duplex Auto Polisher is a robust polishing machine designed for field polishing of 3M HotMelt connectors with the performance of a factory polish.

The receptacle of the machine has a clamp mechanism, that allows to polish two HotMelt (ST, SC or FC) connectors of the same type at a time.

This polishing machine is designed for high volume installations of HotMelt connectors and ensures an extremely high consistency of the polishing quality.

Technical Data:

Voltage (primary)	230V/50Hz, wallsocket PS
Voltage (secondary)	15V DC / 1A, plus on centre
Dimensions:	170 x 185 x 120 cm
Weight:	1,7 kg
Timer intervals:	30, 60, 90, 120 sec.



3M HotMelt Autopolisher

Type/Order text

Ref.-No.



HotMelt Autopolisher, 230V

incl. 230V wall socket power supply and
polishing film 2µm with hole (50 ea)
PU: 1 pc

6851-E



Polishing film, 2µm

with hole for 6851-E Autopolisher
PU: 50 pcs

6192-B



Tubing Kit

This Tubing or Breakout Kit is for direct termination of HotMelt connectors on loose tube cables with 250µm primary coated fibres. The 900µm buffer tube slides over the primary coated fibre and offers more mechanical protection as well as better strain relief on the connector.

DE-0100-0900-4

Kit Content:

- Transparent PP-tube (60 m)
- Heatshrink tube 6,4, x 50 mm with glue (25 ea)
- Metal protection tube for the separation zone loose tube/buffer tubes (25 ea)
- Colour rings for coding (12 different colours, 10 ea colour)
- Instruction manual

8.2 Assembly Systems

8.2.2 3M™ Crimplok™ Connectors

Description

Crimplok™

The Crimplok™ connector combines the speed of non-adhesive connectors with the performance characteristics of epoxy and Hot Melt connectors. Crimplok™ Connectors are the ideal solution for emergency restoration work or for quickly making fibre connections at the desk.

Crimplok connectors were designed to:

- Save time in installation
- Provide rugged, reliable performance, meeting or exceeding current EIA/TIA 568, ISO 11801 and EN 50173 specifications.
- Install cleanly and simply with fewer parts and tools.

Available in both SC and ST, single mode and multimode connector versions, Crimplok connectors are faster to install than epoxy connectors since there is no set-up or curing time. Crimplok connectors do not require special heating tools or ovens, so time spent searching for electrical outlets is eliminated. Polishing the connector is also a simple process that can be performed in seconds.

The Crimplok connector incorporates proven 3M malleable metal element fibre gripping technology. There is no fibre splice or second joint inside the connector, so there is no added attenuation at the connection. When the conformable metal element closes, it grips a length of the fibre, eliminating fibre movement associated with other crimp-style connectors. The strength of the metallic element ensures that Crimplok connectors meet industry standards for temperature and humidity.



ST Connector

SC Connector

Highlights:

- quick, simple and safe assembly in the field
- no adhesive required
- simple manual polishing process
- all connectors contain a pre-radiused Zirconia ferrule
- anti-bend design boot
- suitable for all LAN and CATV applications
- minimal tools required
- no electricity required
- meets EIA/TIA-568 specifications

Type/Order text

Ref.-No.



Crimplok assembly case

6955

Contents of case:

1. Crimping pliers, universal
2. 6955-T Activation Tool
3. Polishing film 2µ, 200 discs
4. Polishing film 0,05µ, 50 discs
5. Polishing pad
6. Plastic bottle, empty
7. Special scissors
8. Stripping tool for cable sheath
9. Stripping tool for coating
10. Microscope, illuminated, 100X
11. Cleaning cloth, 100-pieces
12. Polishing puck
13. Assembly instructions
14. Carrying case

The Crimplok assembly kit for ST and SC connectors, contains all the tools and consumables needed for assembly. Supplied in a convenient carrying case.



Activation Tool, ST/SC

PU: 1 pc

6955-T



Polishing film 2µm, oval with adhesive back

PU: 200 pcs

SP-00503

8.2 Assembly Systems

8.2.3 3M™ Fibrlok™

Description

Fibrlok™ Universal

Fibrlok is a universal mechanical splice, which can be used wherever quick and secure splice connections are required.

Fibrlok Universal splice consists of a highly resistant plastic base, body, and lid, in which a metallic element provides the connection. The metal element surrounds the optical fibres to be connected aligning the fibres precisely and permanently in place.

The universal splice utilizes a single cleave length for both 250 and 900µm coated fibres and has the ability to compensate for variations in fibre outer diameters for improved splicing yield.

The Fibrlok Universal splice can be used with multimode and single-mode fibres with 125 µm diameter and coatings of 250 to 900 µm.

Apply in

- Overhead cable joints
- In-ground joints
- Assembly shafts
- Cable branching boxes
- Building wiring

Connector type	Fibrlok™
Fibre diameter	125µm
Coating	250 to 900 µm
Life cycle	> 30 years (Arrhenius DIN/IEC 88 T1)
Assembly time	<30 s after preparation of fibre ends
Insertion loss	mean = 0,1 dB
Return loss	>35 dB from -40°C to +80°C >60 dB at room temperature
Fibre pull strength	>4,5 N, typically 13 N
Material	highly temperature-resistant plastic with aluminium alloy metal element UL 94, V-0 value
Operating temperature	-40°C to +80°C
Temperature cycle	Change of insertion loss: <0.5 dB. from -40°C to +80°C
Fungus resistance	ASTM G-21-70; value 0
Vibration	EIA standard FOTP-11, test procedure 1
Water resistance	7 days at +43° C, change in attenuation <=0.05 dB

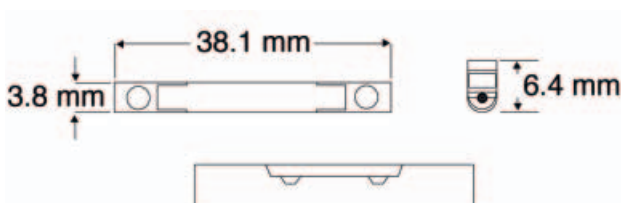

Highlights:

- Fibrlok™ is a universal splice for both 250 to 900 µm coated fibres
- The same splice is used for either singlemode or multimode fibres
- Identical stripping lengths are used for 250/900 µm fibres
- Repositioning of fibres is possible

Fibrlok™ 2529 universal connector for optical fibres

The following diagram illustrates the distribution of results from measuring the insertion loss on 550 Fibrlok™ universal connectors (equal optical fibres, coating: 250 µm).

Mean insertion loss: 0.07 dB.

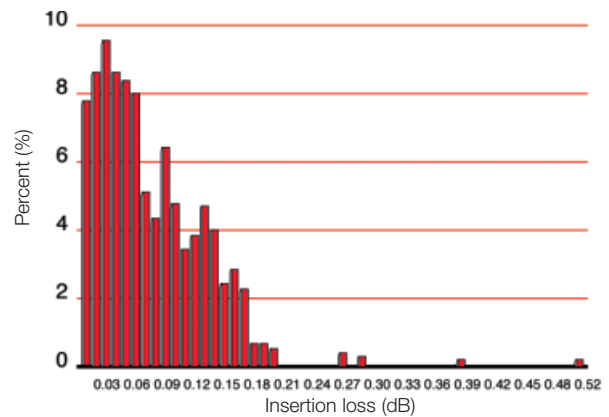

Cross-section of an open and closed Fibrlok™ Universal

To make the connection, the prepared fibre ends are inserted into the connector. Using the assembly tool, the connector lid is closed, and the metal element positions the fibres accurately together.

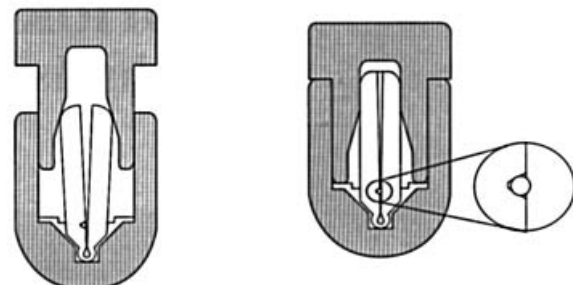

8.2 Assembly Systems

8.2.3 3M™ Fibrlok™



Type/Order text

Ref.-No.

Fibrlok™ Universal



- Kit Content:
- 2501 assembly tool
 - T&B Cleaver (for 2530 only)
 - Microstrip fibre stripper
 - Miller cable stripper
 - Ideal cable stripper
 - Scissors
 - Empty plastic bottle
 - Lint free cloths (100 ea)
 - Carrying case

Fibrlok™ Universal Tool Kit

For production of mechanical splicing connections with Fibrlok Universal, splice. All required tools in a convenient case.
PU: 1 set in carrying case

Complete	2530
Without Cleaver	2531



Fibrlok™ Universal, single fibre mechanical splice

The Fibrlok Universal splice for optical glass fibres can be used with single-mode or multimode fibres with 125 µm diameter and coatings of 250 to 900 µm.
PU: 60 pcs

2529



Fibrlok™ Universal Splice Holder

To accommodate 6 Fibrlok Universal splice connectors, single, in Quante DIN splicing cassette
PU: 20 pcs

2529-H



T&B Cleaver

Fibre cleaving tool for Universal Fibrlok™
PU: 1 pc
Contents of case:
- Cleaver
- Clamp for table mounting

80-6105-7226-7



Fibrlok Holder and Actuator

This new accessory for the 2529 Fibrlok Mechanical Splice is a holder and actuator in one combined design. Now it is possible to pre-terminate Fibrloks in Termination Boxes.

2539

Based upon Fibrlok technology, 3M develops an extended range of cost effective and craft friendly interconnect products especially targeted towards the FTTH-Market, which will be offered shortly. For more details please contact your local sales representative.

8.3 Cable Assemblies

8.3.1 3M™ Multimode Patch Cords

Description

Patch Cords ST-ST / SC-SC

Only standard length patch cords are available from stock. Please contact your local 3M customer service first for stock status.

Technical data:

Adhesive type:	Epoxy
Fibre type:	50/125, OM2 50/125, OM3
Insertion Loss:	< 0,3 dB typ.
Return Loss:	≥ 20 dB typ.
Ferrule:	Zirconia Ceramic
Housing:	Metal (ST) Plastic, grey (SC)
Boot colour:	Black/red (ST-duplex) Black/beige (SC-duplex)
Operating Temperature:	-40°C to 60°C
Storage Temperature:	-40°C to 80°C
Cable Type:	I-VH 2G50/125, LSZH
Jacket colour:	grey or orange

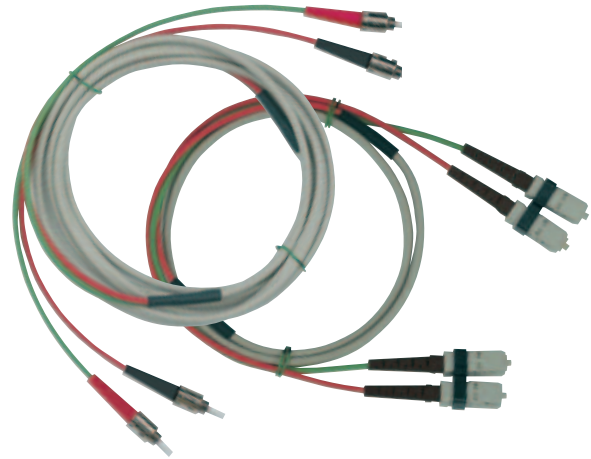

ST-ST Patch Cords

ST-SC Patch Cords

Type/Order text

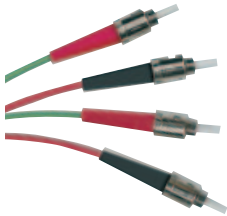

ST-ST Patch cords, multimode, duplex	
50/125µm, grey or orange jacket colour, zip cord	
Length: 1 m	PU: 12 pcs
Length: 2 m	PU: 12 pcs
Length: 3 m	PU: 12 pcs
Length: 5 m	PU: 12 pcs

Ref.-No.

BANAN-AX0001
BANAN-AX0002
BANAN-AX0003
BANAN-AX0005

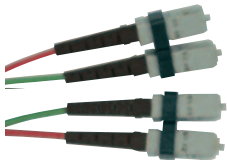

SC-SC Patch cords, multimode, duplex	
50/125µm, grey or orange jacket colour, zip cord	
Length: 1 m	PU: 12 pcs
Length: 2 m	PU: 12 pcs
Length: 3 m	PU: 12 pcs
Length: 5 m	PU: 12 pcs

BDBDB-AX0001
BDBDB-AX0002
BDBDB-AX0003
BDBDB-AX0005

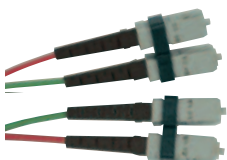

SC-SC Patch cords, multimode, duplex, OM3	
50/125µm, grey or orange jacket colour, zip cord	
Length: 1 m	PU: 12 pcs
Length: 2 m	PU: 12 pcs
Length: 3 m	PU: 12 pcs
Length: 5 m	PU: 12 pcs

BDBDB-CB0001
BDBDB-CB0002
BDBDB-CB0003
BDBDB-CB0005

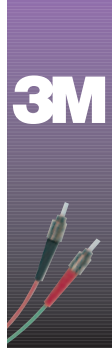

8.3 Cable Assemblies

8.3.1 3M™ Multimode Patch Cords

Description

Patch Cords ST-SC / MTRJ-ST / MTRJ-SC

Only standard length patch cords are available from stock. Please contact your local 3M customer service first for stock status.

Technical Data:

Adhesive type:	Epoxy
Fibre type:	50/125, OM2 50/125, OM3
Insertion Loss:	< 0,3 dB typ.
Return Loss:	≥ 20 dB typ.
Ferrule:	Zirconia Ceramic
Housing:	Metal (ST) Plastic, grey (SC) Plastic, black (MTRJ)
Boot colour:	Black/red (ST) Black/beige (SC)
Operating Temperature:	-40°C to 60°C
Storage Temperature:	-40°C to 80°C
Cable Type:	I-VH 250/125, LSZH
Jacket colour:	grey or orange

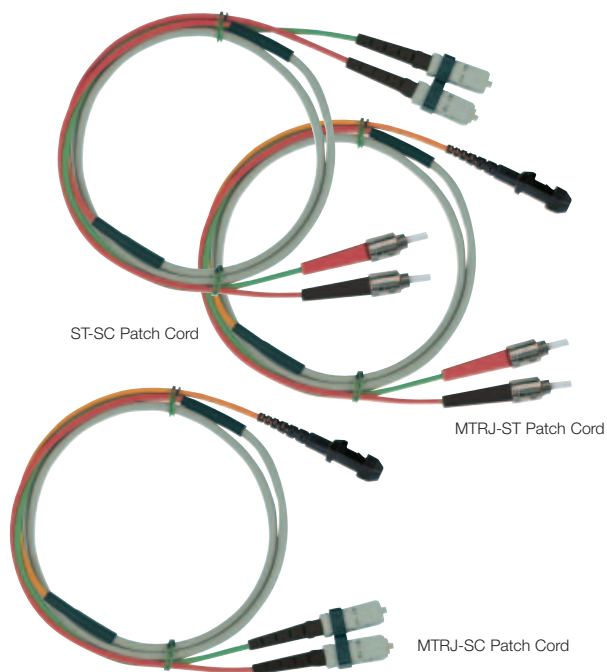

Type/Order text

Ref.-No.

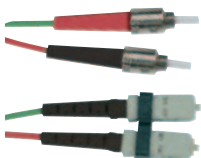

ST-SC Patch cords, multimode, duplex

50/125µm, grey or orange jacket colour, zip cord

Length: 1 m	PU: 12 pcs
Length: 2 m	PU: 12 pcs
Length: 3 m	PU: 12 pcs
Length: 5 m	PU: 12 pcs

BANDB-AX0001
BANDB-AX0002
BANDB-AX0003
BANDB-AX0005

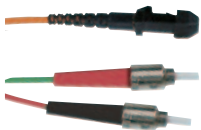

MTRJ-ST Patch cords, multimode, duplex

50/125µm, grey or orange jacket colour, zip cord

Length: 1 m	PU: 12 pcs
Length: 2 m	PU: 12 pcs
Length: 3 m	PU: 12 pcs
Length: 5 m	PU: 12 pcs

BANMT-CT0001
BANMT-CT0002
BANMT-CT0003
BANMT-CT0005

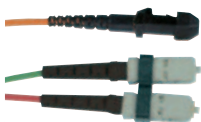

MTRJ-SC Patch cords, multimode, duplex, OM3

50/125µm, grey or orange jacket colour, zip cord

Length: 1 m	PU: 12 pcs
Length: 2 m	PU: 12 pcs
Length: 3 m	PU: 12 pcs
Length: 5 m	PU: 12 pcs

BDBMT-CT0001
BDBMT-CT0002
BDBMT-CT0003
BDBMT-CT0005

8.3 Cable Assemblies

8.3.1 3M™ Multimode Patch Cords

Description

Patch Cords SC-LC / LC-LC

Only standard length patch cords are available from stock. Please contact your local 3M customer service first for stock status.

Technical Data:

Adhesive type:	Epoxy
Fibre type:	50/125, OM2 50/125, OM3
Insertion Loss:	< 0,3 dB typ.
Return Loss:	≥ 20 dB typ.
Ferrule:	Zirconia Ceramic
Housing:	Plastic, grey
Boot colour:	White (LC) Black/beige (SC)
Operating Temperature:	-40°C to 60°C
Storage Temperature:	-40°C to 80°C
Cable Type:	I-VH 250/125, LSZH
Jacket colour:	grey or orange

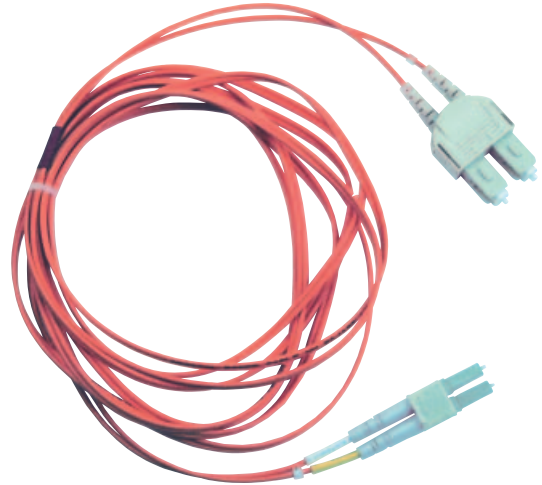

SC-LC Patch Cord

Type/Order text

Ref.-No.



SC-LC Patch cords, multimode, duplex 50/125/2000µm, grey or orange jacket colour, zip cord

Length: 1 m	PU: 12 pcs
Length: 2 m	PU: 12 pcs
Length: 3 m	PU: 12 pcs
Length: 5 m	PU: 12 pcs

BDBDU-AX0001
BDBDU-AX0002
BDBDU-AX0003
BDBDU-AX0005



SC-LC Patch cords, multimode, duplex, OM3 50/125/2000µm, grey or orange jacket colour, zip cord

Length: 1 m	PU: 12 pcs
Length: 2 m	PU: 12 pcs
Length: 3 m	PU: 12 pcs
Length: 5 m	PU: 12 pcs

BDBDU-CB0001
BDBDU-CB0002
BDBDU-CB0003
BDBDU-CB0005



LC-LC Patch cords, multimode, duplex 50/125/2000µm, grey or orange jacket colour, zip cord

Length: 1 m	PU: 12 pcs
Length: 2 m	PU: 12 pcs
Length: 3 m	PU: 12 pcs
Length: 4 m	PU: 12 pcs

BDUDU-AX0001
BDUDU-AX0002
BDUDU-AX0003
BDUDU-AX0004



LC-LC Patch cords, multimode, duplex, OM3 50/125/2000µm, grey or orange jacket colour, zip cord

Length: 1 m	PU: 12 pcs
Length: 2 m	PU: 12 pcs
Length: 3 m	PU: 12 pcs
Length: 5 m	PU: 12 pcs

BDUDU-CB0001
BDUDU-CB0002
BDUDU-CB0003
BDUDU-CB0005

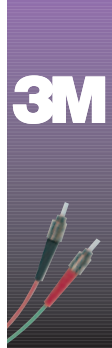

8.3 Cable Assemblies

8.3.2 3M™ Single-mode Patch Cords

Description

Patch Cords ST-ST / ST-SC / SC-SC

Only standard length patch cords are available from stock. Please contact your local 3M customer service first for stock status.

Technical Data:

Adhesive type:	Epoxy
Fibre type:	9/125
Insertion Loss:	< 0,2 dB typ.
Return Loss:	≥ 55 dB typ.
Ferrule:	Zirconia Ceramic
Housing:	Plastic, blue (SC) Metal (ST)
Boot colour:	Yellow (ST) White (SC)
Operating Temperature:	-40°C to 85°C
Storage Temperature:	-40°C to 80°C
Cable Type:	I-VH 19/125, LSZH
Jacket colour:	yellow



Type/Order text

Ref.-No.

	ST-ST Patch cords, single-mode, simplex 9/125µm, yellow jacket colour		
	Length: 1 m	PU: 12 pcs	AAMAM-AT0001
	Length: 2 m	PU: 12 pcs	AAMAM-AT0002
	Length: 3 m	PU: 12 pcs	AAMAM-AT0003
	Length: 5 m	PU: 12 pcs	AAMAM-AT0005
	ST-SC Patch cords, single-mode, simplex 9/125µm, yellow jacket colour		
	Length: 1 m	PU: 12 pcs	AAMDA-AT0001
	Length: 2 m	PU: 12 pcs	AAMDA-AT0002
	Length: 3 m	PU: 12 pcs	AAMDA-AT0003
	Length: 5 m	PU: 12 pcs	AAMDA-AT0005
	SC-SC Patch cords, single-mode, simplex 9/125µm, yellow jacket colour		
	Length: 1 m	PU: 12 pcs	ADADA-AT0001
	Length: 2 m	PU: 12 pcs	ADADA-AT0002
	Length: 3 m	PU: 12 pcs	ADADA-AT0003
	Length: 5 m	PU: 12 pcs	ADADA-AT0005

8.3 Cable Assemblies

8.3.2 3M™ Single-mode Patch Cords

Description

Patch Cords SC/APC 8°-SC/PC SC/APC 8°-SC/APC 8°

Only standard length patch cords are available from stock. Please contact your local 3M customer service first for stock status.

Technical Data:

Adhesive type:	Epoxy
Fibre type:	9/125
Insertion Loss:	< 0,2 dB typ.
Return Loss:	≥ 70 dB typ.
Ferrule:	Zirconia Ceramic
Housing:	Plastic, blue (SC/PC) Plastic, green (SC/APC)
Boot colour:	Green (APC) White (SC)
Operating Temperature:	-40°C to 85°C
Storage Temperature:	-40°C to 80°C
Cable Type:	I-VH 19/125, LSZH
Jacket colour:	yellow

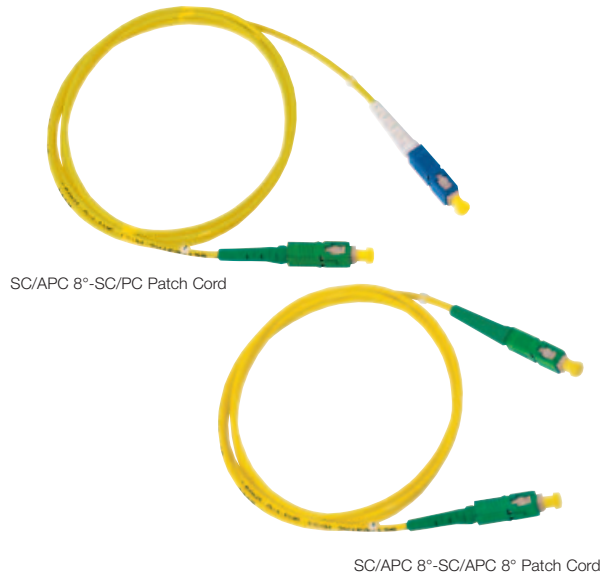

Type/Order text

Ref.-No.

	SC/APC 8°-SC/PC Patch cords, single-mode, simplex		
	9/125µm, yellow jacket colour		
	Length: 1 m	PU: 12 pcs	AEPDA-AT0001
	Length: 2 m	PU: 12 pcs	AEPDA-AT0002
	Length: 3 m	PU: 12 pcs	AEPDA-AT0003
	Length: 5 m	PU: 12 pcs	AEPDA-AT0005
	SC/APC 8°-SC/APC 8° Patch cords, single-mode, simplex		
	9/125µm, yellow jacket colour		
	Length: 1 m	PU: 12 pcs	AEPEP-AT0001
	Length: 2 m	PU: 12 pcs	AEPEP-AT0002
	Length: 3 m	PU: 12 pcs	AEPEP-AT0003
	Length: 5 m	PU: 12 pcs	AEPEP-AT0005

For other cable assemblies, not stated in this catalogue please contact your local 3M sales representative.

8.3 Accessories

8.3.3 3M™ DIN Splicing Cassettes

Description

3M™ FO splicing cassettes manufactured to DIN standards

FO splicing cassette conforming to DIN 47662 and Telecom standards for up to 12 splice connections. Numerous retaining options for FO bunched fibres and single fibres.

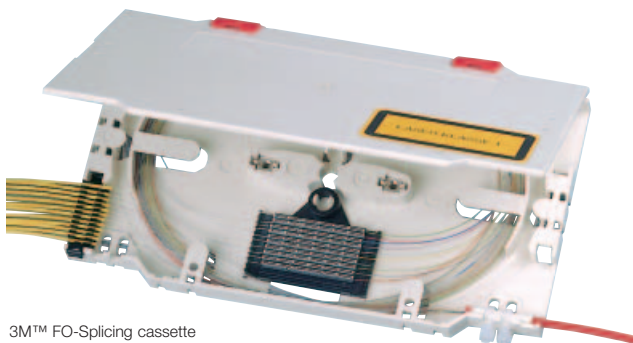

3M™ FO-Splicing cassette

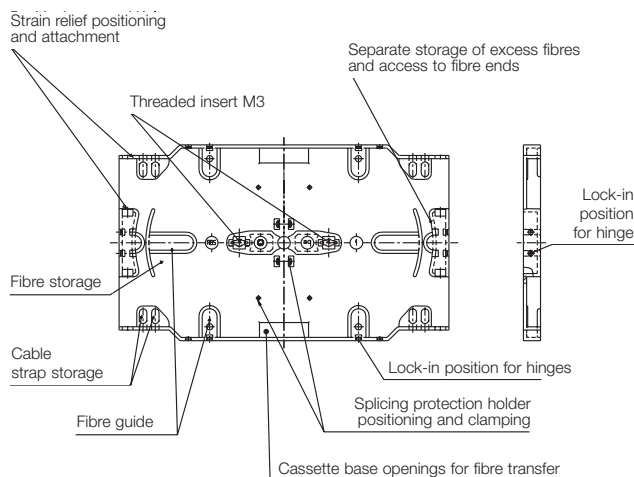

Type/Order text

Ref.-No.



FO-Splicing cassette

Incl. strain relief and cable management
Dimensions: 155 x 92 x 8 mm (HxWxD)
Colour: RAL 9001 (cream white), PU: 10 pcs

29026-500 31



FO-Splicing cassette

Incl. splice protective holder for 12 crimp splice protectors and cable management
Dimensions: 155 x 92 x 8 mm (HxWxD)
Colour: RAL 9001 (cream white), PU: 10 pcs

29026-500 30

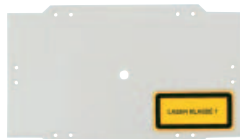

FO Lid

For splicing cassette, colour: RAL 9001 (cream white)
Dimensions: 155 x 92 x 2 mm (HxWxD), colour: RAL 9001 (cream white)
PU: 10 pcs
PU: 50 pcs

29025-503 31

29025-503 30



Hinge

To connect splicing cassette and lid, PU: 100 pcs

03-756-00500



FO-Strain relief

For 12 fibres with Ø 0.9 and 1.1mm coating
PU: 50 pcs

29031-000 30



FO-Splicing protection holder, crimp

PU: 10 pcs, for 12x crimp splice protectors

05-760-08000



FO-Crimp splice protector

PU: 150 pcs

05-760-08100



FO-Splicing protection holder, shrink

PU: 10 pcs, for 6x shrink splice protectors

05-760-11900



FO-Heatshrink splice protector 60 mm FSS 1

PU: 1000 pcs

05-760-12000



FO-Heatshrink splice protector 45 mm FSS 1/2,4

PU: 1000 pcs

05-760-12100



FO-Splicing holder Fibrok™ Universal

PU: 20 pcs, for 6x Fibrok

2529-H



8.4 Distribution Boxes

8.4.1 3M™ VKA 2/GF

Description

3M™ VKA 2/GF

The VKA 2/GF optical fibre distribution box is specifically designed as an interior transfer or termination point for optical fibre runs. It is well-suited to environments where space is limited and a cost effective solution is required.

The VKA 2/GF houses two FO splicing cassettes which can hold up to 24 splice connections. With the addition of a connector mounting plate (optional) the boxes can also be used as a patch distribution frame.

Highlights:

- Splice or patch distribution frame for 24 splice connections (2 FO splicing cassettes)
- FO connector mounting plates for 12 connectors E2000/SC, ST/FC or 6 connectors SC duplex
- accommodates hybrid cables using copper connector blocks, either 2x10 pair or 1x20 pair (SID™-CD). Overvoltage protection can be used
- Lockable
- Remote monitoring via lid contact

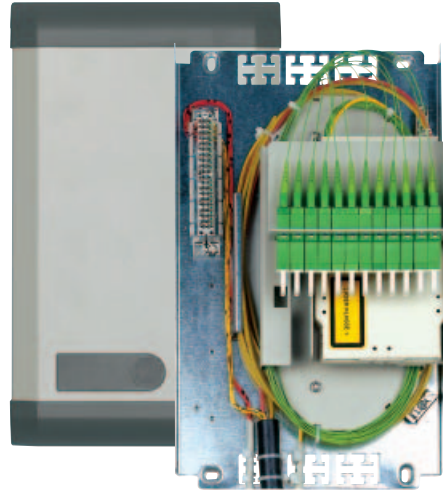

3M™ VKA 2/GF

If hybrid cables are used, the modular design of the VKA 2/GF makes it possible for either two 10 pair or one 20 pair copper connector blocks (Quante™ SID™-CD) to be accommodated.

Protection rating: IP 40 (DIN 40050)

Typ/Bestelltext

Ref.-No.

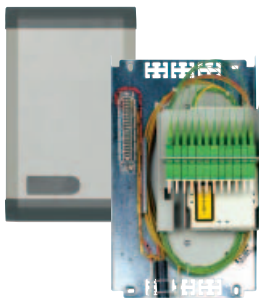

VKA 2/GF for 24 splice connections

Dimensions (HxWxD): 330 x 200 x 100 mm

Weight: approx. 2.1 kg;

PU: 1 unit

Contents:

- Base plate with earth terminal and attachment for copper connector block
- Cassette tray for FO splicing cassettes
- 2 FO splicing cassettes with splice protection holder
- Housing lid with snap closure
- Cable management, assembly instructions

52-303-00030

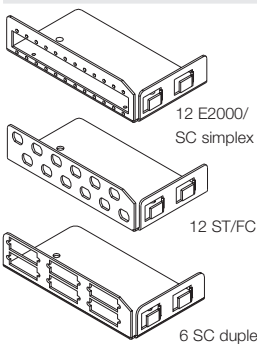

FO connector mounting plates 12 E2000/SC simplex

52138-019 30

FO connector mounting plates 12 ST/FC

52138-018 30

FO connector mounting plates 6 SC duplex

52138-016 30



VKA-Monitoring switch

Lid contact only useable in combination with lock kit

52096-519 00

8.4 Distribution Boxes

8.4.1 3M™ VKA 2/GF-EFM

Description

3M™ VKA 2/GF-EFM with single fibre management

The VKA 2/GF-EFM serves as a final distribution or splice distribution frame in optical fibre networks and is capable of accommodating up to 12 splice connections in six FO splicing cassettes.

A feature of the VKA 2/GF-EFM is that it provides the opportunity for both single and multiple fibre management. This type of fibre management enables the storage of the splice for a connection to be separate from all other fibres. Ideally, two fibres will be stored in one splicing cassette. Using this method to manage the fibres, existing fibre connections will not be affected, even at later extensions or service work.

Highlights:

- Single-fibre management for up to 12 splicing connections (24 fibres)
- FO cassette stack, completely removable
- Separate cable guide levels for incoming and outgoing sides
- Connector holders for SC, ST or FC connections
- Copper connector block for hybrid cables
- Lockable
- Remote monitoring via lid contact
- Utilises the same design as the VKA distribution frame

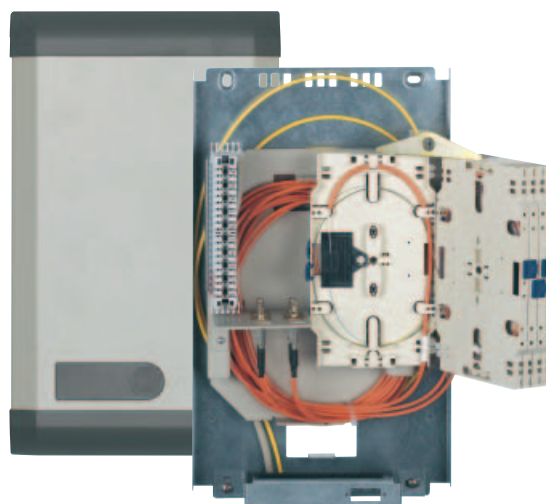

3M™ VKA 2/GF-EFM

By using different connector mounting plates, the VKA 2/GF-EFM can be used as a patch distribution frame. It is possible to install a 10 pair copper connector block (Quante™ SID™-CT) for use with hybrid cables.

Type/Order text

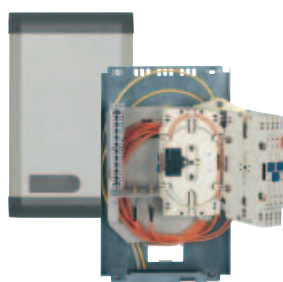

VKA 2/GF-EFM for 12 splice connections

- Protection rating: IP 40 (DIN 40050)
 Dimensions (H x W x D): 330 x 200 x 100 mm
 Weight: approx. 2.1 kg;
 PU: 1 unit
 Contents:
- Base plate with earth terminal and attachment for copper connector block
 - Cassette stack with 6 FO splicing cassettes, hinges and cassette lids included
 - Unlocking tools
 - Cable management
 - Assembly instructions

Ref.-No.

52-303-0000

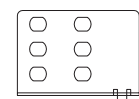

FO connector mounting plates holders 6 ST/FC

52138-009 30

Lock kits

- VKA lock kit Q2
- VKA lock kit Q3
- VKA lock kit Q15

52096-523 00
 52096-521 00
 52096-526 00



VKA-Monitoring switch

Lid contact only useable in combination with lock kit

52096-519 00

8.4 Distribution Boxes

8.4.1 3M™ VKA 4/GF, 3M™ VKA 8/GF

Description

3M™ VKA 4/GF, 3M™ VKA 8/GF

VKA 4/GF and VKA 8/GF are optical fibre distribution frames capable of housing upto 48 and 96 splice connections in either four or eight FO splicing cassettes, respectively. These capacities can be further expanded to 72 or 144 splice connections by the addition of a further 2 or 4 splicing cassettes. In these cases it will not be possible to install a FO connector mounting plate.

Using optional connector mounting plates, the two splice distribution frames can be converted to patch distribution frames.

Highlights:

- Capacity as:
Patch distribution frame, 48 (VKA 4/GF) or 96 (VKA 8/GF) splice connections
Splice distribution frame, 72 (VKA 4/GF) or 144 (VKA 8/GF) splice connections
- Connector mounting plates for SC, E2000, FC or SC connections
- Copper termination for hybrid cables possible with overvoltage protection
- Remote monitoring via lid contact

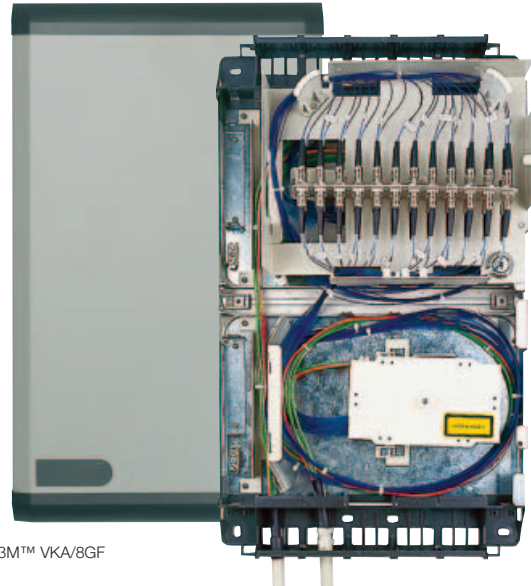

3M™ VKA/8GF

The VKA 4/GF can be equipped with one, the VKA 8/GF with two connector mounting plates. For the use of hybrid cables (with copper leads), there is a provision for the installation of 10 pair copper connector blocks (SID-CT).

Type/Order text

Ref.-No.

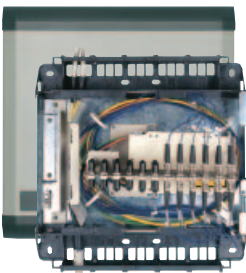

3M™ VKA/4GF

VKA 4/GF for 48 splice connections
VKA 8/GF for 96 splice connections

Protecting rating: IP 40 (DIN 40050)
Dimensions (HxWxD) :330x330x125 mm, 550x330x125 mm
Weight: approx. 2.8 / 4.9 kg;
PU: 1 unit

- Contents:
- Base plate with earth terminal and attachment materials for copper connector blocks
 - Cassette tray for FO splicing cassettes
 - 4 or 8 splicing cassettes with splice protection holder
 - 1 or 2 splicing cassette lids
 - Plastic cable inlets and clamping
 - Housing lid with snap closure
 - Cable management
 - Assembly instructions

52-303-00100
52-303-00200

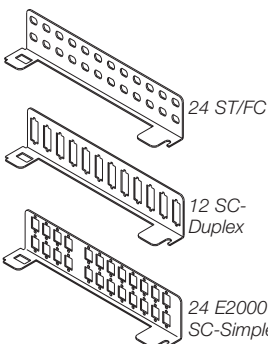

FO connector holders 24 ST/FC

52138-010 30

FO connector holders 12 SC-Duplex

52138-012 30

FO connector holders 24 E2000 / SC-Simplex

52138-013 30

Installation above the FO splicing cassettes



VKA-Monitoring switch

52096-519 00

Lid contact only useable in combination with lock kit

8.4 Distribution Boxes

8.4.2 3M™ 2552SA

Description

3M™ 2552 SA Wallmount distribution box

The 3M 2552SA offers excellent fibre management in an affordable box with an attractive, low profile design able to be wall mounted anywhere in your LAN network. The box is also suitable for housing consolidation points.

The 2552SA series brings efficient use of space as well as functionality and rugged durability. The boxes have a unique sliding lid to provide easy access to couplings and fibre management.

Interchangeable connector panels are available to accommodate: ST simplex & duplex couplings, SC duplex couplings, FC flanged couplings, FC "D" mount couplings, and the Volition™ VF-45™ Socket.

Fibres can either be directly terminated or spliced to pigtails using either Fibrlok™ or fusion splicing. The 2552SA is constructed from flame retardant material.

The 2552SA is part of 3M's large family of fibreoptic products including connectors, couplings cable assemblies splices and more.

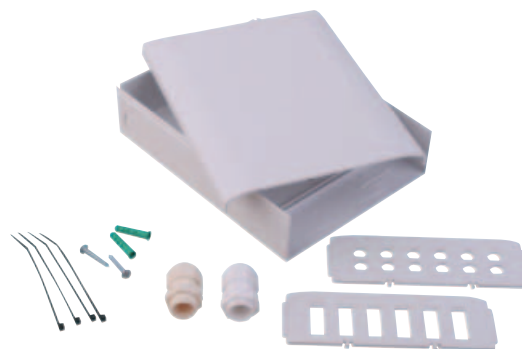

Highlights:

- Assortment of coupling plates will handle all major connector styles

Type/Order text



2552SA

Dimensions (HxWxD) :210 x 160 x 65 mm
 Weight: approx. 0,5 kg/ea.
 MOQ: 10 units

Content:
 Exchangeable face plates for:
 ST simplex /
 FC-"D" Mount /
 SC duplex plate up to 12x fibres

Ref.-No.

2552SA